

LINEPULS

Magnetic sensor with integrated converter

series

SME51



- Standard sensor for linear and rotary axis
- Gap clearance up to 2 mm
- Lika hi-flex sensor cable
- Status LED for clearance error
- Optional reference mark LKM1309/5 to be installed along the magnetic tape
- Optional tape cleaning wipers

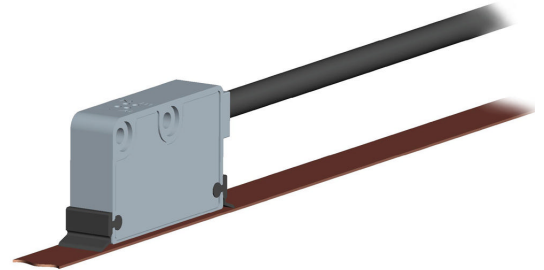

SME51

ENVIRONMENTAL SPECIFICATIONS

Operating temperature range:	-25°C ÷ +85°C (-13°F +185°F)
Storage temperature range:	-40°C ÷ +100°C (-40°F +212°F)
Protection:	IP67

MECHANICAL SPECIFICATIONS

Dimensions:	see drawing
Housing:	die cast aluminium, UNI EN AC-46100
Connection:	Lika Hi-flex cable M8, 2,0 m
Gap sensor-magnetic tape (without cover strip):	0,1 ÷ 2,0 mm
Travel speed:	max 16 m/s (mechanical)
Resolution:	0,05 / 0,025 / 0,01 / 0,005 mm
System accuracy:	±15 µm max.
Repeatability:	±1 increment

ELECTRICAL SPECIFICATIONS

Power supply:	+5Vdc ±5%, +10Vdc ÷ +30Vdc
Output circuits:	Line Driver, Push-Pull
Output signals:	ABI, /ABI
Counting frequency:	acc. to edge distance setting
Output current (per channel):	40 mA max
Input current:	70 mA max
Protection:	against inversion of polarity (except 5Vdc version) and short-circuit

ACCESSORIES

MT50:	Magnetic tape
LKM-1309/5:	Reference pole support
LKM-1440:	Tape terminals
KIT LKM-1722:	Wipers for SMExx/SMSxx, 10 pcs
MRI:	Magnetic ring
PS1:	Protection profile

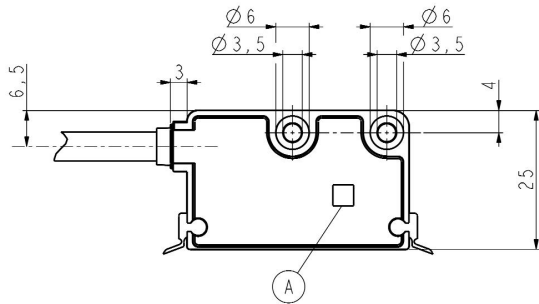

A Reference Sensor (optional)

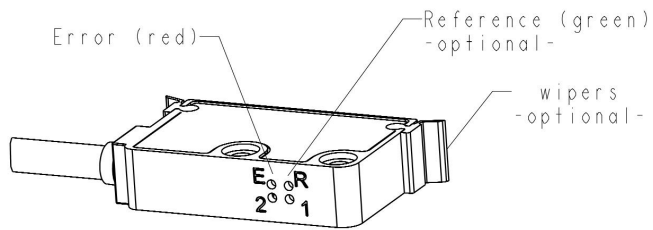
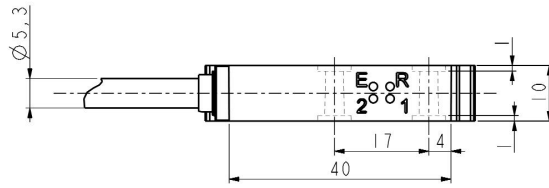

SME51

ORDERING CODE

XXXX	-	XX	-	X	-	XX	-	X
SERIES		OUTPUT CIRCUITS		INDEX		RESOLUTION		EDGE DISTANCE
SME51		Push-Pull (AB) Y Push-Pull (AB, /AB) YC Line Driver (AB, /AB) L		N without I every 5 mm R unique reference signal		50 0,05 mm (50 µm) 25 0,025 mm (25 µm) 10 0,01 mm (10 µm) 5 0,005 mm (5 µm)		H 0,3µs min. edge distance at output* J 0,5µs A 1µs B 2µs C 4µs
POWER SUPPLY								xx Cable length on request Ex: 2= 2 meters 7= 7 meters
+5Vdc ±5% (L) 1								
+10Vdc ÷ +30Vdc (Y and L) 2								