

- Compact positioning unit
- High performance brushless motor
- RD52: integrated motor brake
- Boot loader via CAN



RD5-RD52

### ENVIRONMENTAL SPECIFICATIONS

Operating temperature range:	0°C +60°C (32°F +140°F)
Storage temperature range:	-20°C +80°C (-4°F +176°F)
	(98% R.H. without condensation)
Protection:	IP54

### MECHANICAL SPECIFICATIONS

Dimensions:	see drawing
Shaft hollow:	Ø 14 mm
Shaft loading (axial and radial):	50 N
Positioning accuracy:	± 0,9°
Electrical connections:	3 x M12 connectors
Duty cycle:	45% ED
Torque and shaft rotational speed:	5 Nm @ 60 rpm
Starting torque:	12 Nm
Weight:	~ 1 kg (35.2 oz)

### ELECTRICAL SPECIFICATIONS

Resolution:	1024 inf./rev. x 1024 rev.
Power supply:	+24Vdc ± 10%
Power (motor):	31 W
Input current:	motor: 2 A max. control unit: 80 mA max. (RD5) 480 mA max. (RD52)
Bus Interface:	CANopen (DS301)

### MATERIALS

Flange:	non corroding, UNI EN AW-6082
Housing:	non corroding, UNI EN AW-6082
Bearings:	ABEC 5
Shaft:	stainless steel non-magnetic, UNI EN 4305
Motor:	Brushless motor

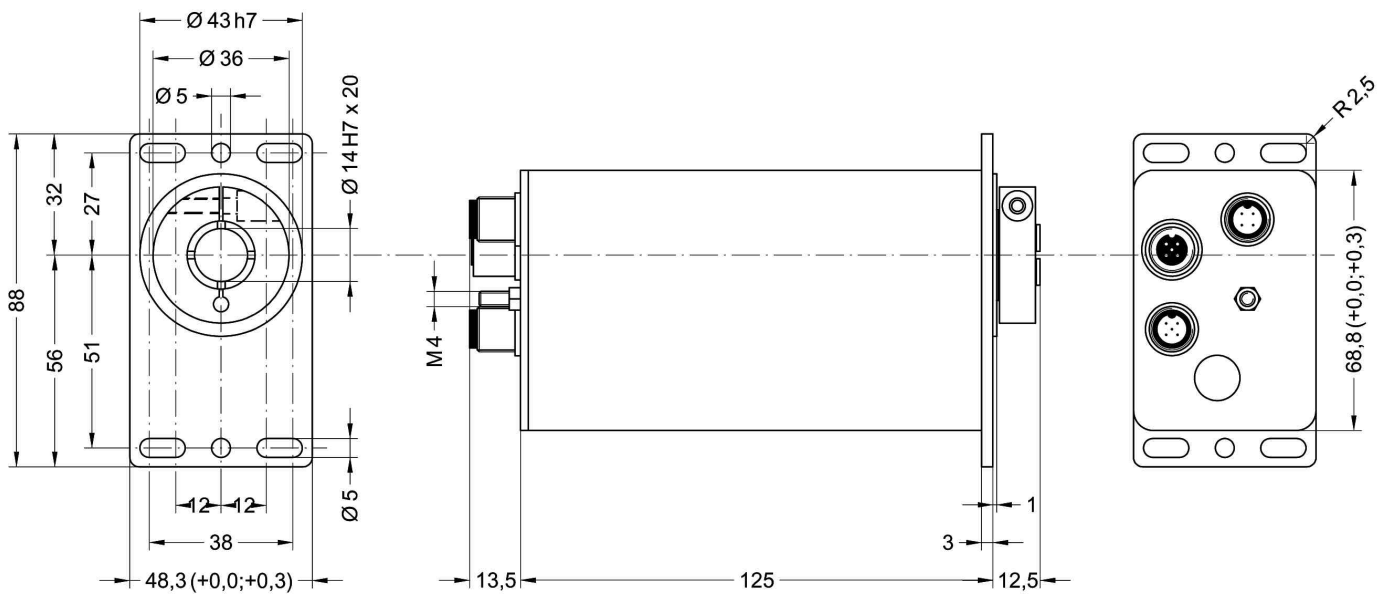

RD5-RD52

ORDERING CODE

